

Storing Breast Milk

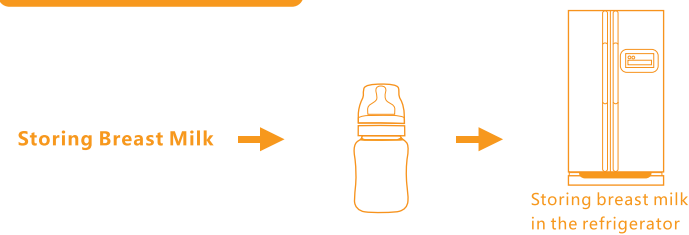

Regularly, It takes 10 minutes to express 60-120ml (2-4OZ) for each side breast. This data is only for reference, if you find every time you express more than 120ml(4OZ), please change to a bigger bottle.

Ways of storing breast milk

1. You can store the breast milk in the refrigerator for 48 hours at approx. 4°C.
2. When freezing milk, allow space at the top of the bottle for expansion.
3. Do not store breast milk in the door of the refrigerator.
4. In order to preserve the nutrition of the breast milk, thaw in the refrigerator overnight or use a bottle warmer and set to 40°C.
5. Never defrost or heat milk in a microwave oven.

Troubleshooting

If there is low or no suction :

1. Please make sure that all connections are secure.
2. Please make sure the silicone insert on the cup forms a complete seal around the breast.
3. Make sure the valve is clean and not damaged.

Attention

1. Before first use, clean the product.
2. Clean before each use.
3. Always wash the product immediately after use.
4. Wash in warm soapy water and rinse in clean water or use a dishwasher. Do not clean with solvents or harsh chemicals.
5. Do not store or leave in direct sunlight or near a source of heat.
6. Do not store with or allow to come into contact with solvents or harsh chemicals.

Cleaning and Hygiene

1. Please disassemble, clean and sterilize all parts of your breast pump kit that come into contact with the breast and milk before and after each use.
2. Please do not clean with solvents or harsh chemicals.

Sterilization

1. When sterilizing by microwave oven, please use a sterilize vessel.
2. You can also choose Trumom microwave sterilizer to sterilize your breast pump and bottle.
3. You can also choose Trumom electric bottle sterilizer to sterilize all the parts of your breast pump.

trumom™ FEEDING Manual Advance Breast Pump



For any query contact:- hello@trumom.com

Component of Adjustable Breast Pump

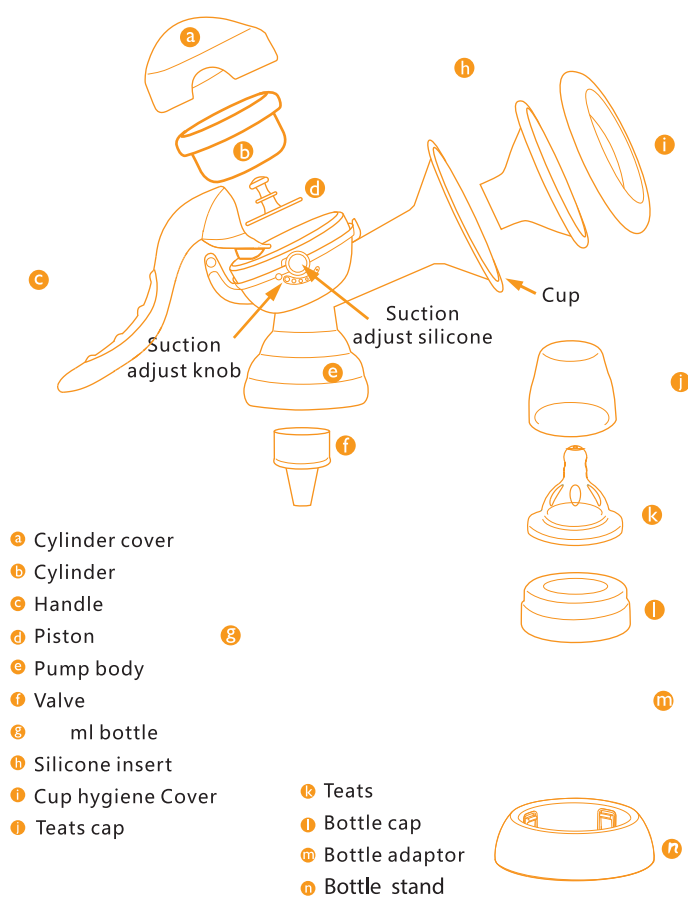

Assembling the Breast Pump

Wash your hands thoroughly before handling the pump. Wash and sterilize your breast pump before using (Follow STERILIZE section).

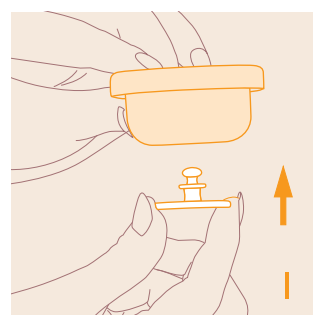

Push piston into cylinder.

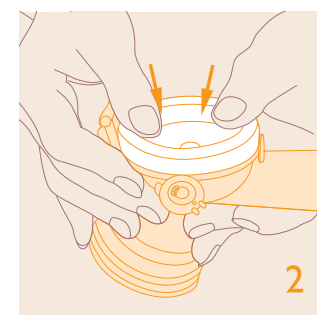

Connect cylinder to pump body,

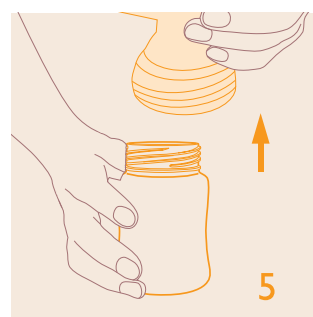

Screw bottle into the pump body.

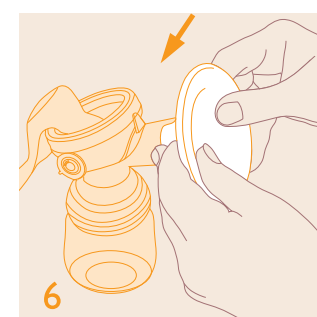

Push the silicone insert onto the pump body, make sure they match tightly.

Assembling the Breast Pump

Wash your hands thoroughly before handling the pump. Wash and sterilize your breast pump before using (Follow STERILIZE section).

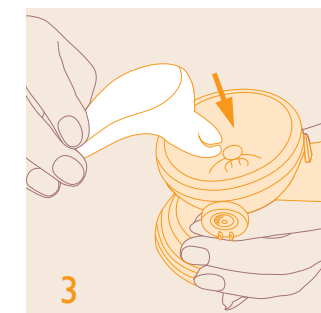

Push the groove of the handle under the piston, press the handle until you hear click.

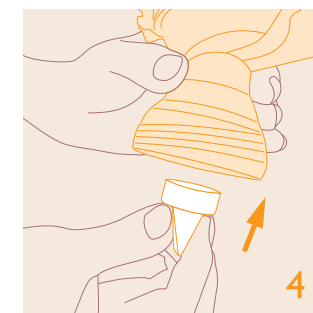

Fix the valve onto the pump body.

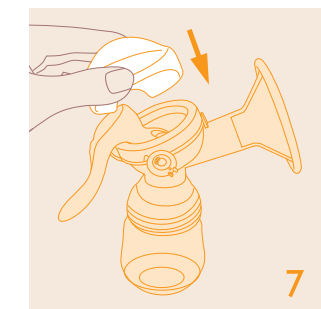

Cover the cylinder cover onto the cylinder.

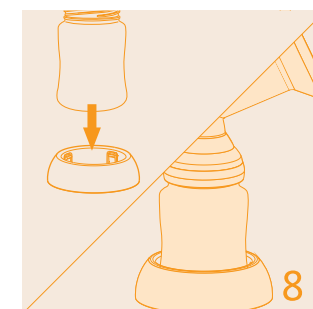

Put the bottle on the base.

How to use breast pump

Be comfortable and relax, you can watch TV or listen to your favorite music.

1. Wash your hands thoroughly before using the breast pump.
2. Make sure the breast pump is assembled correctly.
3. Sit comfortable and relax, prepare to express breast milk.
4. Center your breast shield over your nipple. Make sure the silicone insert on the cup forms a complete seal around the breast.
5. Press and release the handle to imitate a baby's suckling until your milk starts to flow. (You can adjust the suction by revolving the Suction Adjustable Knob)
6. After finishing pumping, take off the bottle.
7. Cover the bottle cover, put into the refrigerator.

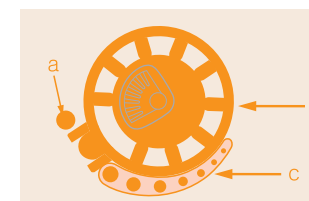

HOW TO USE SUCTION ADJUSTABLE KNOB

Refer to the left picture, position a is the strongest suction, revolve the knob to c direction will adjust the suction.