

ATTENTION

- 1. This appliance shall not be used by children. Keep the appliance and its cord out of reach of children.
- 2. Appliances cannot be used by persons with reduced physical, sensory or mental capabilities or lack of experience and knowledge if they have been given supervision or instruction concerning use of the appliance in a safe way and understand the hazards involved.
- 3. Children shall not play with the appliance.
- 4. If the supply cord is damaged, it must be replaced by the manufacturer, its service agent or similarly qualified persons in order to avoid a hazard.
- 5. This appliance is not intended for bed and breakfast type environments.
- 6. Make sure there is water in the base before sterilizing.
- 7. Be cautious of the high temperature steam.
- 8. Do not touch the stainless steel base when it works.
- 9. Do not make the base immerse into the water, only use the wet cloth to wipe it.
- 10. Please pull out the plug firstly if there is any emergency.

This appliance is intended to be used in household and similar applications such as:

- 1. Staff kitchen areas in shops, offices and other working environments;
- 2. Farm houses;
- 3. By clients in hotels, motels and other residential type environments;

Specifications

Name: Bottle Sterilizer
Model: BSM01
Voltage: 220V~50Hz
Power: 600W

For any query contact:- customercare@nureca.com



Bottle Sterilizer
and Food Steamer



- ✓ Sterilize 6 bottles in 9 minutes
- ✓ Sterilize bottles, nipples and other feeding supplies
- ✓ One button operation convenient for your use.



Components of feeding bottle sterilizer

Continuous high temperature steam sterilization, Complete eliminates the bacteria on the bottle and other items very fast. Sterilize 6 bottles in 9 minutes, fast and convenient for your use.
Small volume with big capacity, sterilize all feeding supplies at the same time. After finishing sterilizing, automatically turn off.

All the components are made of baby safe plastic, resistant to heat upto 110°C

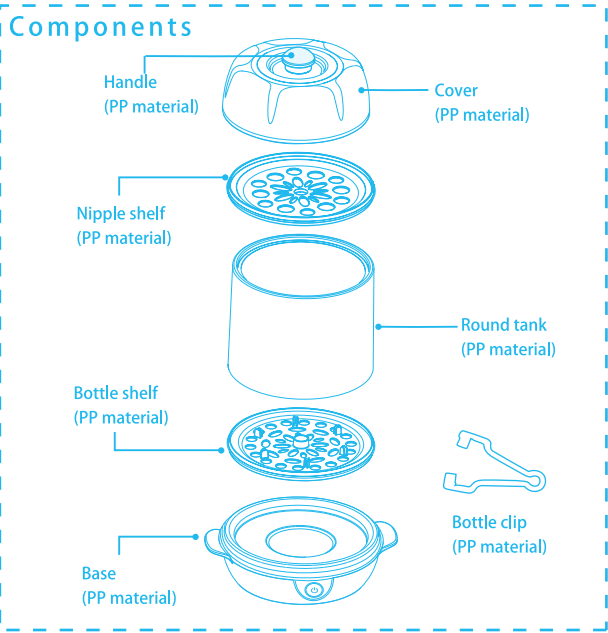

HOW TO USE BOTTLE STERILIZER

Sterilization



1 Pour 100ml of Pure Water into the heating plate.



2 Place the bottles in the sterilizer. Make sure that the sterilizer is placed on a platform, leveled and secured against movement. Close the cover.

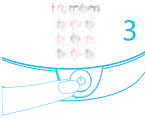

3 Plug in and press the ON/OFF button to turn ON the sterilizer which will turn the indicator light on. Machine will automatically turn off, once the water is evaporated. Do not remove the bottles, nipples & other feeding supplies before it cools down.
Note:- Sterilization time is about 9 minutes

Steam Food



1 Pour 100ml of pure water in the sterilizer (Add more water if required as per the volume of food).



2 Put the food on the shelf and close the cover.

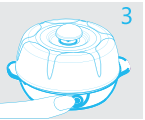

3 Plug in and press the ON/OFF button which will turn the indicator light ON. Machine automatically turns off once the water is evaporated.
Note:- Steaming time is about 9 minutes